

# CWC 750 V2

Compact Height

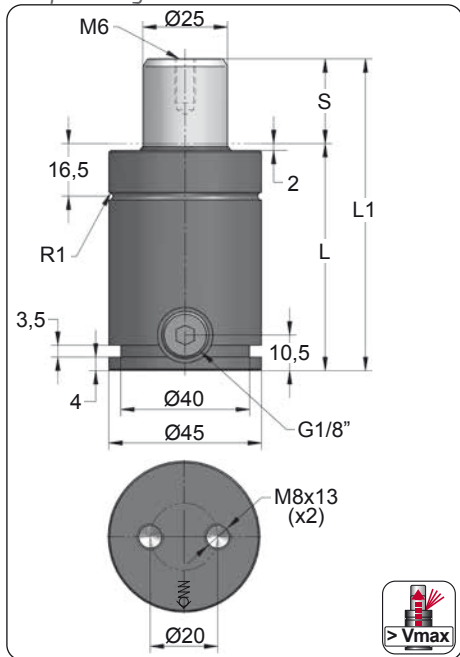

| ORDER          | S (mm) | L1 ±0,25 (mm) | L (mm) | Kg.  |
|----------------|--------|---------------|--------|------|
| CWC 750 010 V2 | 10     | 62            | 52     | 0.49 |
| CWC 750 013 V2 | 13     | 68            | 55     | 0.50 |
| CWC 750 016 V2 | 16     | 74            | 58     | 0.52 |
| CWC 750 019 V2 | 19     | 80            | 61     | 0.54 |
| CWC 750 025 V2 | 25     | 92            | 67     | 0.58 |
| CWC 750 032 V2 | 32     | 106           | 74     | 0.62 |
| CWC 750 038 V2 | 38     | 118           | 80     | 0.66 |
| CWC 750 050 V2 | 50     | 142           | 92     | 0.74 |
| CWC 750 063 V2 | 63     | 168           | 105    | 0.82 |
| CWC 750 075 V2 | 75     | 192           | 117    | 0.89 |
| CWC 750 080 V2 | 80     | 202           | 122    | 0.92 |
| CWC 750 100 V2 | 100    | 242           | 142    | 1.05 |
| CWC 750 125 V2 | 125    | 292           | 167    | 1.20 |



| CODE             |  | bar | psi  | F <sub>0</sub> daN | F <sub>1</sub> daN |
|------------------|--|-----|------|--------------------|--------------------|
| CWC 750 050 V2   |  | 150 | 2175 | 740                | 1175               |
| CWC-H 750 050 V2 |  | 0   | 0    | ---                | ---                |

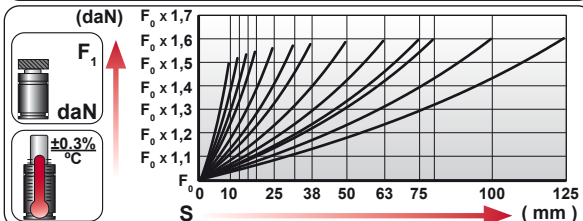
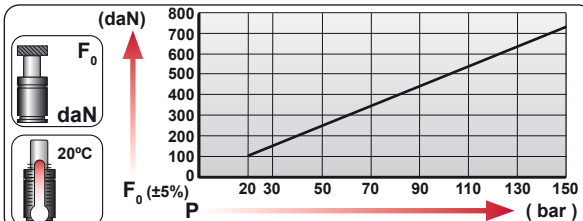

|  |   |                |                    |  |      |
|--|---|----------------|--------------------|--|------|
|  | ENG ORDER<br>DEU BESTELLUNG<br>FRA COMMANDE<br>ITA ORDINE<br>ESP PEDIDO<br>POR PEDIDO |                | F <sub>0</sub> daN |  | S mm |
|  |   | CWC 750        | 50                 |  |      |
|  |   | CWC 750 050 V2 |                    |  |      |

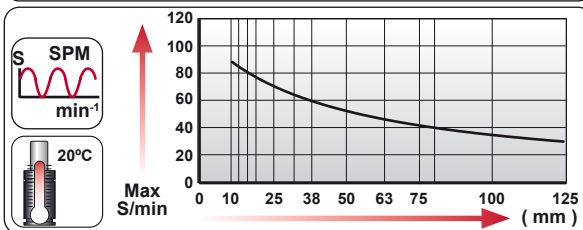

|                |                        |                          |                         |                         |                  |                  |  |         |
|----------------|------------------------|--------------------------|-------------------------|-------------------------|------------------|------------------|--|---------|
|                |                        |                          |                         |                         |                  |                  |  |         |
| N <sub>2</sub> | S <sub>max</sub> < 90% | V <sub>max</sub> 1,6 m/s | P <sub>min</sub> (20°C) | P <sub>max</sub> (20°C) | T <sub>min</sub> | T <sub>max</sub> |  | 600 CP- |

|     |     |     |      |    |    |    |     |  |
|-----|-----|-----|------|----|----|----|-----|--|
| bar | psi | bar | psi  | °C | °F | °C | °F  |  |
| 20  | 290 | 150 | 2175 | 0  | 32 | 80 | 176 |  |

|  |       |         |
|--|-------|---------|
|  |       |         |
|  | MODEL | CWC 750 |

|                  |                   |
|------------------|-------------------|
| <p><b>CW</b></p> | <p><b>CWC</b></p> |
|------------------|-------------------|

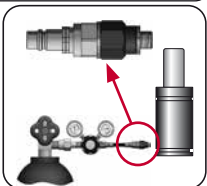
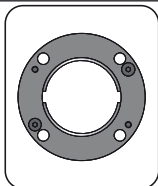
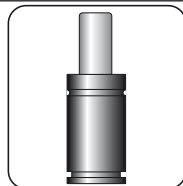

| CODE           | CWC 750 050 V2    | KIT S-XXXXXXX<br>KIT C-XXXXXXX | A14-045 | 18 CG 1-Q            |
|----------------|-------------------|--------------------------------|---------|----------------------|
| ENG ORDER      | GAS SPRING        | REPAIR KIT                     | FLANGE  | CHARGING ADAPTER     |
| DEU BESTELLUNG | GASDRUCKFEDER     | ERSATZTEILSATZ                 | FLANSCH | LADEADAPTER          |
| FRA COMMANDE   | RESSORT À GAZ     | KIT DE RÉPARATION              | BRIDE   | RACCORD DE CHARGE    |
| ITA ORDINE     | CILINDRO AD AZOTO | KIT DI MANUTENZIONE            | FLANGE  | ADATTATORE DI CARICO |
| ESP PEDIDO     | RESORTE DE GAS    | KIT DE REPARACION              | BRIDA   | ADAPTADOR DE CARGA   |
| POR PEDIDO     | CILINDRO DE GÁS   | KIT DE MANUTENÇÃO              | FLANGE  | ADAPTADOR DE CARGA   |

**CW 750 V1/CWC 750 V2 MOUNTS****AZOL  
GAS**

Compact Height

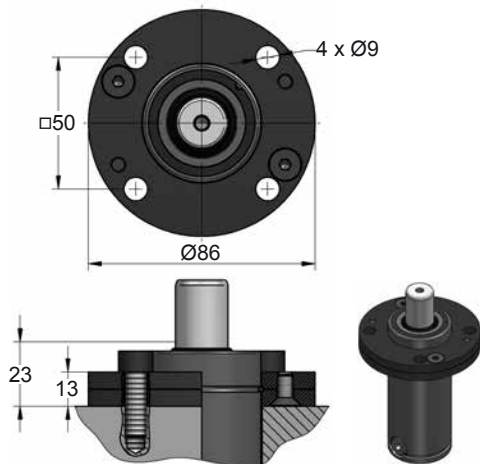
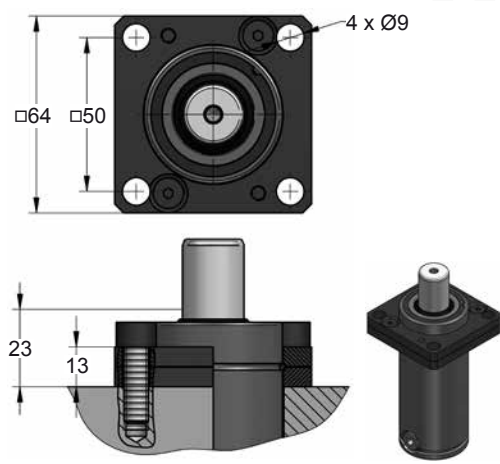
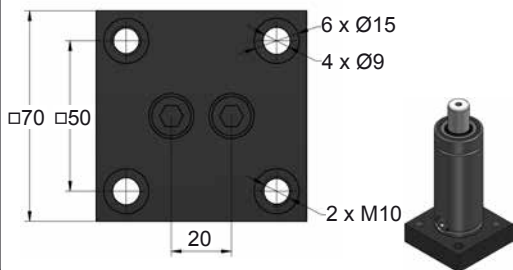
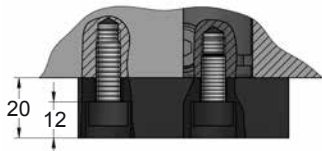
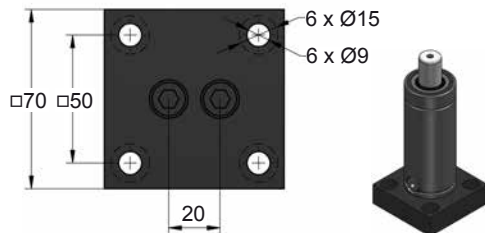
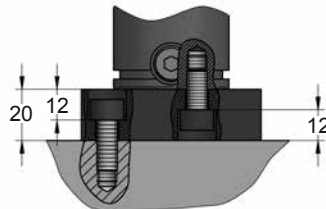
**A14-045**E24.54.815.G  
EM24.54.700F**A34-045****B36-045****B41-045**

**SEAL  
KIT S-XXXXXXX**

**CARTRIDGE  
KIT C-XXXXXXX**

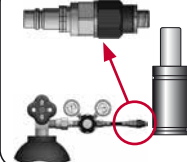
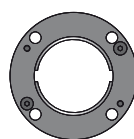

| CODE | CWC 750 050 V2 | KIT S-XXXXXXX<br>KIT C-XXXXXXX | A14-045             | 18 CG 1-Q |                      |
|------|----------------|--------------------------------|---------------------|-----------|----------------------|
| ENG  | ORDER          | GAS SPRING                     | REPAIR KIT          | FLANGE    | CHARGING ADAPTER     |
| DEU  | BESTELLUNG     | GASDRUCKFEDER                  | ERSATZTEILSATZ      | FLANSCHEN | LADEADAPTER          |
| FRA  | COMMANDE       | RESSORT À GAZ                  | KIT DE RÉPARATION   | BRIDE     | RACCORD DE CHARGE    |
| ITA  | ORDINE         | CILINDRO AD AZOTO              | KIT DI MANUTENZIONE | FLANGE    | ADATTATORE DI CARICO |
| ESP  | PEDIDO         | RESORTE DE GAS                 | KIT DE REPARACION   | BRIDA     | ADAPTADOR DE CARGA   |
| POR  | PEDIDO         | CILINDRO DE GÁS                | KIT DE MANUTENÇÃO   | FLANGE    | ADAPTADOR DE CARGA   |