





Referans Nr.	dx 	x L	b	a	e	k	Tightening Data		
							Nm	kN	
1610-0606025	M6x6	x25	15	5.7	10	4	17	17	19
1610-0606040		x40	28						25
1610-0606063		x63	40						36
1610-0808032	M8x8	x32	22	7.7	12	6	43	32	39
1610-0808050		x50	35						45
1610-0808080		x80	50						56
1610-1010040	M10x10	x40	23	9.7	15	6	79	51	65
1610-1010063		x63	45						80
1610-1010080		x80	50						90
1610-1010100	x100	60	110						
1610-1012050	M10x12	x50	35	11.7	18	7	79	51	85
1610-1012063		x63	40						95
1610-1012080		x80	55						100
1610-1012100	x100	60	110						
1610-1012125	x125	75	125						
1610-1012160	x160	90	140						
1610-1012200	x200	120	160						
1610-1212050	M12x12	x50	35	11.7	18	7	141	74	120
1610-1212063		x63	40						128
1610-1212080		x80	55						140
1610-1212100	x100	65	160						
1610-1212125	x125	75	170						
1610-1212160	x160	100	195						
1610-1212200	x200	120	220						
1610-1214050	M12x14	x50	35	13.7	22	8	141	74	140
1610-1214063		x63	45						150
1610-1214080		x80	55						155
1610-1214100	x100	65	175						
1610-1214125	x125	75	195						
1610-1214160	x160	100	220						
1610-1214200	x200	120	240						
1610-1416063	M14x16	x63	45	15.7	25	9	223	101	200
1610-1416080		x80	55						230
1610-1416100		x100	65						245
1610-1416125	x125	75	270						
1610-1416160	x160	100	310						
1610-1416200	x200	120	340						
1610-1416250	x250	150	390						
1610-1616063	M16x16	x63	45	15.7	25	9	354	138	260
1610-1616080		x80	55						285
1610-1616100		x100	65						310
1610-1616125	x125	85	345						
1610-1616160	x160	100	385						
1610-1616200	x200	120	435						
1610-1616250	x250	150	505						
1610-1618063	M16x18	x63	45	17.7	28	10	354	138	290
1610-1618080		x80	55						305
1610-1618100		x100	65						340
1610-1618125	x125	85	370						
1610-1618160	x160	100	415						
1610-1618200	x200	120	460						
1610-1618250	x250	150	525						
1610-1820080	M18x20	x80	55	19.7	32	12	474	169	405
1610-1820100		x100	65						435
1610-1820125		x125	85						480
1610-1820160	x160	110	535						
1610-1820200	x200	125	610						
1610-1820250	x250	150	680						
1610-1820315	x315	190	790						
1610-2020080	M20x20	x80	55	19.7	32	12	679	215	480
1610-2020100		x100	65						515
1610-2020125		x125	85						570
1610-2020160	x160	110	635						
1610-2020200	x200	125	725						
1610-2020250	x250	160	820						
1610-2020315	x315	190	950						
1610-2022080	M20x22	x80	55	21.7	35	14	679	215	530
1610-2022100		x100	65						565
1610-2022125		x125	85						620
1610-2022160	x160	110	690						
1610-2022200	x200	125	775						
1610-2022250	x250	150	880						
1610-2022315	x315	190	1050						

Referans Nr.	dx 	x L	b	a	e	k	Tightening Data		
							Nm	kN	
1610-2224080	M22x24	x80	55	23.7	40	16	903	266	700
1610-2224100		x100	65						740
1610-2224125		x125	85						805
1610-2224160	x160	110	890						
1610-2224200	x200	125	1000						
1610-2224250	x250	150	1115						
1610-2224315	x315	190	1280						
1610-2424100	M24x24	x100	70	23.7	40	16	1163	310	885
1610-2424125		x125	85						970
1610-2424160		x160	110						1060
1610-2424200	x200	125	1180						
1610-2424250	x250	150	1320						
1610-2424315	x315	190	1515						
1610-2424400	x400	240	1750						
1610-2428100	M24x28	x100	70	27.7	44	18	1163	310	1000
1610-2428125		x125	85						1065
1610-2428160		x160	110						1150
1610-2428200	x200	125	1280						
1610-2428250	x250	150	1425						
1610-2428315	x315	190	1640						
1610-2428400	x400	240	1870						
1610-2428500	x500	290	2170						
1610-3036125	M30x36	x125	80	35.6	54	22	2258	493	1900
1610-3036160		x160	110						2065
1610-3036200		x200	135						2250
1610-3036250	x250	150	2500						
1610-3036315	x315	200	2770						
1610-3036500	x500	300	3630						
1610-3642160	M36x42	x160	100	41.6	65	26	3953	719	3310
1610-3642250		x250	175						3930
1610-3642400		x400	250						5010
1610-3642600	x600	340	6900						
1610-4248160	M42x48	x160	100	47.6	75	30	6337	986	4600
1610-4248250		x250	175						5600
1610-4248400		x400	250						7200

DIN 787
Product Nr. 1610 T-Slot Bolt with Nut and Washer

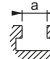
- Quality 12.9
- Black coating

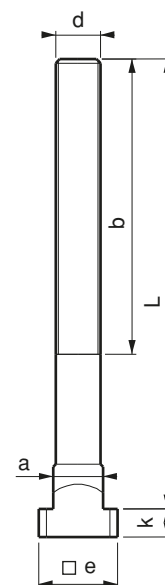

Loctite 8150

Note: Environments on the 150 °C when clamping action on the thread Loctite 8150 is used.