

Referans Nr.	dx	x L	b	a	e	k	Tightening Data		
							Nm	kN	
1590-0606025	M6x6	x25	15	5.7	10	4	17	17	8
1590-0606040		x40	28						11
1590-0606063		x63	40						15
1590-0808032	M8x8	x32	22	7.7	12	6	43	32	13
1590-0808050		x50	35						16
1590-0808080		x80	50						20
1590-1010040	M10x10	x40	23	9.7	15	6	79	51	35
1590-1010063		x63	45						45
1590-1010080		x80	50						60
1590-1010100	x100	60	70						
1590-1012050	M10x12	x50	35	11.7	18	7	79	51	50
1590-1012063		x63	40						60
1590-1012080		x80	55						65
1590-1012100		x100	60						75
1590-1012125		x125	75						90
1590-1012160		x160	90						105
1590-1012200	x200	120	120						
1590-1212050	M12x12	x50	35	11.7	18	7	141	74	65
1590-1212063		x63	40						70
1590-1212080		x80	55						80
1590-1212100		x100	65						100
1590-1212125		x125	75						110
1590-1212160		x160	100						140
1590-1212200	x200	120	160						
1590-1214050	M12x14	x50	35	13.7	22	8	141	74	80
1590-1214063		x63	45						90
1590-1214080		x80	55						100
1590-1214100		x100	65						110
1590-1214125		x125	75						135
1590-1214160		x160	100						160
1590-1214200	x200	120	180						
1590-1416063	M14x16	x63	45	15.7	25	9	223	101	115
1590-1416080		x80	55						140
1590-1416100		x100	65						160
1590-1416125		x125	75						180
1590-1416160		x160	100						220
1590-1416200		x200	120						255
1590-1416250	x250	150	300						
1590-1616063	M16x16	x63	45	15.7	25	9	354	138	140
1590-1616080		x80	55						160
1590-1616100		x100	65						190
1590-1616125		x125	85						225
1590-1616160		x160	100						270
1590-1616200		x200	120						315
1590-1616250	x250	150	380						
1590-1618063	M16x18	x63	45	17.7	28	10	354	138	170
1590-1618080		x80	55						185
1590-1618100		x100	65						220
1590-1618125		x125	85						245
1590-1618160		x160	100						295
1590-1618200		x200	120						340
1590-1618250	x250	150	405						
1590-1820080	M18x20	x80	55	19.7	32	12	474	169	260
1590-1820100		x100	65						290
1590-1820125		x125	85						340
1590-1820160		x160	110						390
1590-1820200		x200	125						455
1590-1820250		x250	150						535
1590-1820315	x315	190	650						
1590-2020080	M20x20	x80	55	19.7	32	12	679	215	300
1590-2020100		x100	65						330
1590-2020125		x125	85						380
1590-2020160		x160	110						450
1590-2020200		x200	125						535
1590-2020250		x250	160						635
1590-2020315	x315	190	760						
1590-2022080	M20x22	x80	55	21.7	35	14	679	215	345
1590-2022100		x100	65						380
1590-2022125		x125	85						435
1590-2022160		x160	110						500
1590-2022200		x200	125						590
1590-2022250		x250	150						695
1590-2022315	x315	190	820						

Referans Nr.	dx	x L	b	a	e	k	Tightening Data		
							Nm	kN	
1590-2224080	M22x24	x80	55	23.7	40	16	903	266	465
1590-2224100		x100	65						515
1590-2224125		x125	85						580
1590-2224200		x160	110						660
1590-2224250		x200	125						775
1590-2224315	x250	150	805						
1590-2224315	x315	190	1050						
1590-2424100	M24x24	x100	70	23.7	40	16	1163	310	550
1590-2424125		x125	85						630
1590-2424160		x160	110						725
1590-2424200		x200	125						850
1590-2424250		x250	150						990
1590-2424315	x315	190	1180						
1590-2424400	x400	240	1410						
1590-2428100	M24x28	x100	70	27.7	44	18	1163	310	660
1590-2428125		x125	85						730
1590-2428160		x160	110						820
1590-2428200		x200	125						950
1590-2428250		x250	150						1090
1590-2428315	x315	190	1300						
1590-2428400	x400	240	1530						
1590-2428500	x500	290	1800						
1590-3036125	M30x36	x125	80	35.6	54	22	2258	493	1280
1590-3036160		x160	110						1440
1590-3036200		x200	135						1620
1590-3036250		x250	150						1880
1590-3036315		x315	200						2150
1590-3036500	x500	300	3010						
1590-3642160	M36x42	x160	100	41.6	65	26	3953	719	2260
1590-3642250		x250	175						2890
1590-3642400		x400	250						4010
1590-3642600	x600	340	5900						
1590-4248160	M42x48	x160	100	47.6	75	30	6337	986	3550
1590-4248250		x250	175						4530
1590-4248400		x400	250						6160

DIN 787
Product Nr. 1590 T-Slot Bolt

- Quality 12.9
- Black coating



Loctite 8150

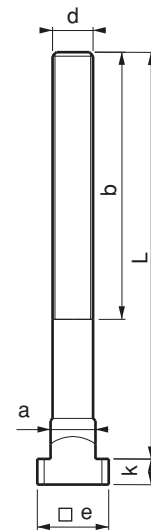

Note: Environments on the 150 °C when clamping action on the thread Loctite 8150 is used.

