

CA.02 GWP

L/X/JU

. T-Nut

. Nutensteine für Profil

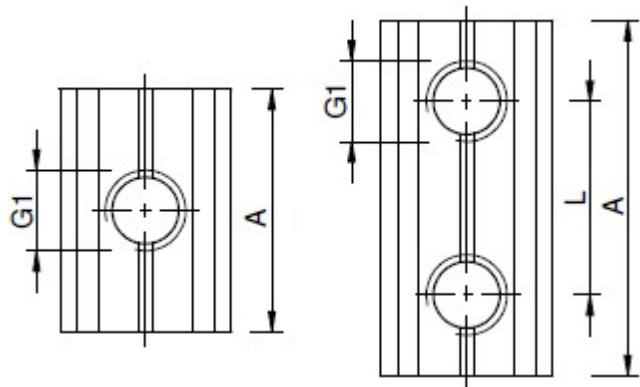
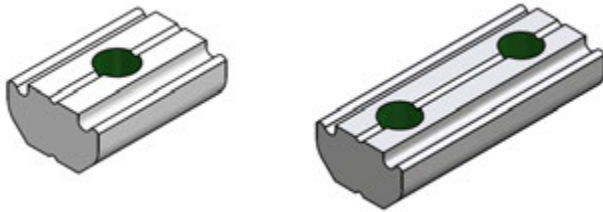

Suitable for Profiles L/X/JU
Passend für Profile L/X/JU

Article no.	G1	L	A	Weight
CA.GWP.3U	M3	...	15	6 g

Article no.	G1	L	A	Weight
CA.GWP.4U	M4	...	15	6 g
CA.GWP.4.8		8	16	
CA.GWP.4.9		9	19	7 g
CA.GWP.4.16		16	24	9 g
CA.GWP.4.17		17	25	10 g
CA.GWP.4.25		25	32	13 g
CA.GWP.4.LM		...	10	4 g

New

Article no.	G1	L	A	Weight
CA.GWP.5U	M5	...	15	6 g
CA.GWP.5.9		9	18	
CA.GWP.5.10		10	18	
CA.GWP.5.11		11	19	7 g
CA.GWP.5.12		12	22	8 g
CA.GWP.5.15		15	25	9 g
CA.GWP.5.17		17		
CA.GWP.5.20		20	30	11 g
CA.GWP.5.22		22	32	12 g
CA.GWP.5.25		25	33	12 g
CA.GWP.5.25.3		25 x 2	58	22 g
CA.GWP.5.28		28	38	13 g
CA.GWP.5.30		30	40	16 g
CA.GWP.5.35		35	45	18 g
CA.GWP.5.38		38	48	19 g
CA.GWP.5.40		40		
CA.GWP.5.40.3		40	88	35 g
CA.GWP.5.50		50	58	23 g
CA.GWP.5.52		52	64	26 g
CA.GWP.5.60		60	68	27 g
CA.GWP.5.75		75	83	34 g
CA.GWP.5.LM	...	10	3 g	

New

Article no.	G1	L	A	Weight
CA.GWP.6U	M6	...	15	4 g
CA.GWP.6.12		12	24	8 g
CA.GWP.6.16		16	26	9 g
CA.GWP.6.20		20	30	11 g
CA.GWP.6.22		22	32	12 g
CA.GWP.6.25		25	35	13 g
CA.GWP.6.25.3			58	22 g
CA.GWP.6.28		28	40	15 g
CA.GWP.6.35		35	45	17 g
CA.GWP.6.40		40	50	19 g
CA.GWP.6.50		50	60	24 g
CA.GWP.6.52		52	64	25 g
CA.GWP.6.90		90	100	40 g
CA.GWP.6.LM		...	10	2 g

New

Material: Steel galvanized
Werkstoff: Stahl verzinkt

Article no.	L	Weight
CA.GWP.500	500	212g
CA.GWP.1000	1000	420 g

