

CA.09 PAC

. Sensor

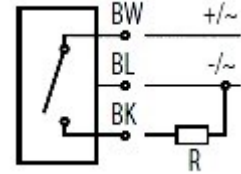
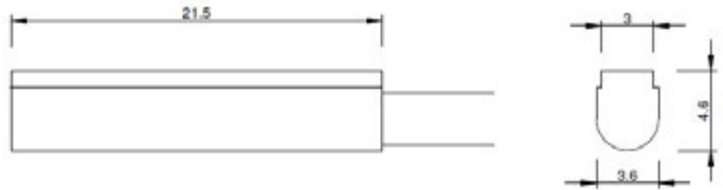

. Sensor

Article no.	Sensor	Weight
KT58PM8	3 wires REED PNP normally Open M8 plug connector	4g
KT58NM8	3 wires REED NPN normally Open M8 plug connector	

Power supply	3÷30 Vac/dc
Switching current	0.2 A
Power rating (ohmic load)	6 W
Standard cable length	0.3 m

. Insert

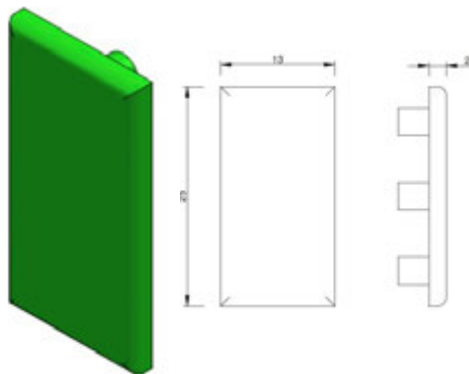

. Einlage

Article no.		Colour	Weight
PAC.20.16P.03.V	VITON	Green	4g

	VITON
UV ageing, weather -resistance <i>UV-halterung, Witterungsbeständigkeit</i>	☺
Low temperature limit <i>Niedrige Temperaturgrenze</i>	-10°C
High temperature limit (continuous) <i>Hohe Temperaturgrenze (kontinuierlich)</i>	180°C
High temperature limit (< 30 sec.) <i>Hohe Temperaturgrenze (< 30 sec.)</i>	210°C
Leaving few marks <i>Einige Spuren bleiben</i>	☺